

Fulflo® CH Multi-Cartridge Filter Vessel

Carbon steel, 304 and 316 stainless steel filter vessel (non ASME code)

The Fulflo® CH non-code filter vessels are lightweight and provide economical filtration of liquids. The vessel features the integrity of a swing bolt for fast, easy opening and closing. It comes with standard zinc plated bolts and legs for corrosion resistance but is also offered with stainless steel options. Wall mounting brackets are available as well.

The Fulflo CH vessel series accommodates either double-open-end (DOE) or single-open-end (SOE) 222/flat or 222 flex fin filter cartridges in 10 inch, 20 inch or 30 inch lengths.

The CH filter vessel series replaces the FH filter vessel series.



Contact Information

Parker Hannifin Corporation
Industrial Process Filtration - N.A.
118 Washington Avenue
Mineral Wells, TX 76067

phone +1 940 325 2575
industrialprocess.na@parker.com

www.parker.com/industrialprocess

Benefits

- Single O-ring design closure assures quick, positive cover sealing
- Swing bolts for fast and easy opening and closing of cover
- Pivot pin cover allows cover to remain attached when opened
- Commercial engineering design - Non-code
- Zinc plated closure bolts and legs for corrosion resistance
- Adjustable leg height
- Standard features include vent, clean drain & dirty drain connections
- Optional mounting wall bracket (P/N 0820-6005)

Applications

- Potable Water
- Lubricants
- Process Water
- Coolants
- Edible Oils
- Cutting oils
- Coatings
- Solvents



ENGINEERING YOUR SUCCESS.

Fulflo® CH Multi-Cartridge Filter Vessels

Available Finishes

- Enamel exterior paint on carbon steel models
- Glass bead blast finish on stainless models

Number of Cartridges

Five 10 inch, 20 inch or 30 inch x 2.70" OD (Max) end caps

Product Configurations

Pipe size or connection:
2" NPT inlet & outlet
1/2" NPT vent
3/4" NPT drain

Fulflo® CH Vessel Series

Rated Capacity
25gpm, 50gpm, 75gpm

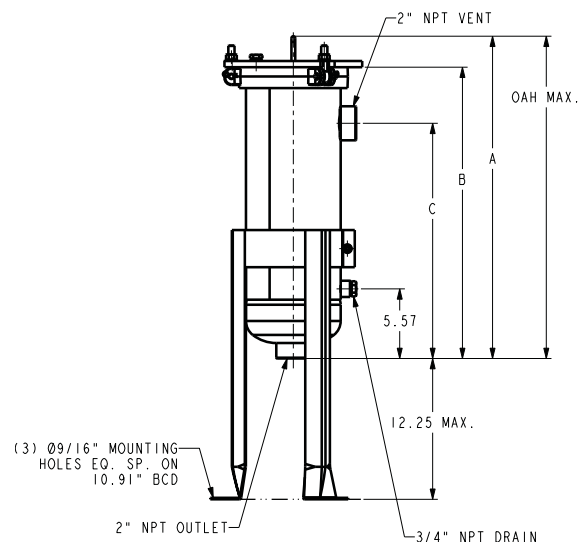
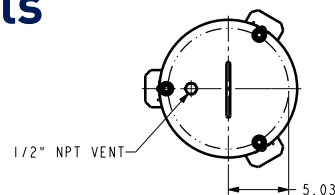

Cartridge Configurations	
222 O-ring SOE	Flat
	PP spring closed end
Gasket SOE	Flex fin
	PP spring closed end
DOE	Standard
	Extended Core

Optional Shell O-Ring/Gasket*	
Material	Part #
Nitrile/Buna-N (Std.)	4150-5706
EPDM	4150-5708
FKM (Viton®)	4150-5707
Fluoropolymer	4150-5790

*Optional O-ring shipped separately

Model	Dimensions			Shipping Wt. (lbs)
	A	B	C	
CHC5S2T	26	23.5	19.00	57
CHC5D2T	36	33.5	29.00	67
CHC5T2T	46	43.5	39.00	77
CHG5S2T	26	23.5	19.00	57
CHG5D2T	36	33.5	29.00	67
CHG5T2T	46	43.5	39.00	77
CHS5S2T	26	23.5	19.00	57
CHS5D2T	36	33.5	29.00	67
CHS5T2T	46	43.5	39.00	77

Material of Construction	Max. Allowable Pressure (MAP) (psi @ MAT °F)	Max. Allowable Temp. (MAT) (°F @ MAP psi)
Carbon Steel	175psi (12.1bar)	400°F (204°C)* **
304 Stainless	175psi (12.1bar)	400°F (204°C)**
316 Stainless	175psi (12.1bar)	400°F (204°C)**

*Limited to 250°F by the paint

**Limited to 250°F by the standard Buna-N O-ring

Ordering Information

CH	<input type="text"/>	5	<input type="text"/>	<input type="text"/>	<input type="text"/>		
Material		Element Length		Inlet/Outlet Size		Support Options	
Code	Description	Code	Inches	Code	Inches	Code	Description
C	Carbon Steel	S	10	2T	2" NPT	Blank	Zinc plated carbon steel legs
G	304 Stainless Steel	D	20			W	Wall Mounted/No legs
S	316 Stainless Steel	T	30			SL	Stainless steel legs
						SB	Stainless steel cover bolts
						SS	Stainless steel bolts & legs

Example Part# Configuration for Orders (no dashes):
CHC5S2T
CHG5D2TSL

Specifications are subject to change without notification.
For User Responsibility Statement, see www.parker.com/safety

© 2017 Parker-Hannifin Corporation
Industrial Process Filtration - North America
All Rights Reserved

Fulflo is a registered trademark of Parker-Hannifin Corporation
Viton is a registered trademark of E.I. DuPont de Nemours & Co., Inc.

